



ELEMENTARY SCHOOL EXPANSION PROJECT

OCTOBER 21, 2020



Agenda

- Project History
 - Review of Enrollment and Space Considerations
 - Alternatives
 - Current and Conceptual Design-Huckleberry Hill
 - Current and Conceptual Design-Sumer Street
 - Cost, Funding and Construction Timeline
 - Important Dates
- 

Project History

➤ 2018

- The School Enrollment and Capacity Exploration Committee was appointed by the Board of Selectmen and School Committee
 - Review the trend of increased enrollment at the elementary level and make a recommendation of future space considerations to support the educational goals of the Lynnfield Public Schools
 - The committee's findings and final recommendation was that both elementary schools would require additional space to accommodate the increase in enrollment

➤ 2020

- The School Building Committee was formed to act upon the final recommendation of the School Enrollment and Capacity Exploration Committee and undertake all actions related to the expansion of both elementary schools
 - The recommendation from the Building Committee is to construct additions at each school along with additional school improvements as set forth in the conceptual design plans

Enrollment and Space Considerations

- Current Enrollment – Huckleberry Hill
 - 452 students attending hybrid or full remote
 - 18 students not attending this year but expected to return for the 2021-2022 school year
 - Total student population: 470 students
- Current Enrollment – Summer Street
 - 392 students attending hybrid or full remote
 - 23 students not attending this year but expected to return for the 2021-2022 school year
 - Total student population: 415 students
- Total Number of Classrooms available 2020-2021: 42 district wide (HHS: 22/SSS: 20/885 students)
 - Expected need 2021-2022: 43 classrooms (Enrollment projection: 931 students)
 - Expected need 2022-2023: 46 classrooms (Enrollment projection: 978 students)
 - Expected need 2023-2024: 47 classrooms (Enrollment projection: 1,002 students)
 - Expected need 2024-2025: 48 classrooms (Enrollment projection: 1,030 students)
 - **Number of classrooms needed are based projected enrollments using NESDEC (New England School Development Council) data**

Alternatives to Address Increased Enrollment

- Art and Music on a Cart
 - Putting these programs on a cart or removing them from a dedicated teaching space will jeopardize the integrity of the instruction by limiting the resources that can be used and projects that can be completed
- Redistricting
 - Both HHS and SSS are both presently at capacity so redistricting does not solve the space issues
- Larger Class Size
 - Expand the current class size guidelines
 - Using today's enrollment and forecast the average class size would be 25-27 kids, using the assumption that the student population is split evenly between the two schools (2020-2021 breakdown is 54% @ HHS and 46% at SSS)
 - 2020-2021 average class size is between 18-22 depending on grade level
- Relocate the Pre-School
 - Only affects Summer Street, and would only gain 2 classrooms when the need is for 5
 - Would require multiple new positions to be staffed
 - PS would need its own Director, OT/PT, Nurse instead of leveraging these resources available at Summer Street School

Current and Conceptual Design-Huckleberry Hill

Huckleberry Hill School Existing Floor Plan

HUCKLEBERRY HILL ELEMENTARY SCHOOL

3/25/2020

EXISTING CONDITIONS PLAN 20/21 ACADEMIC YEAR

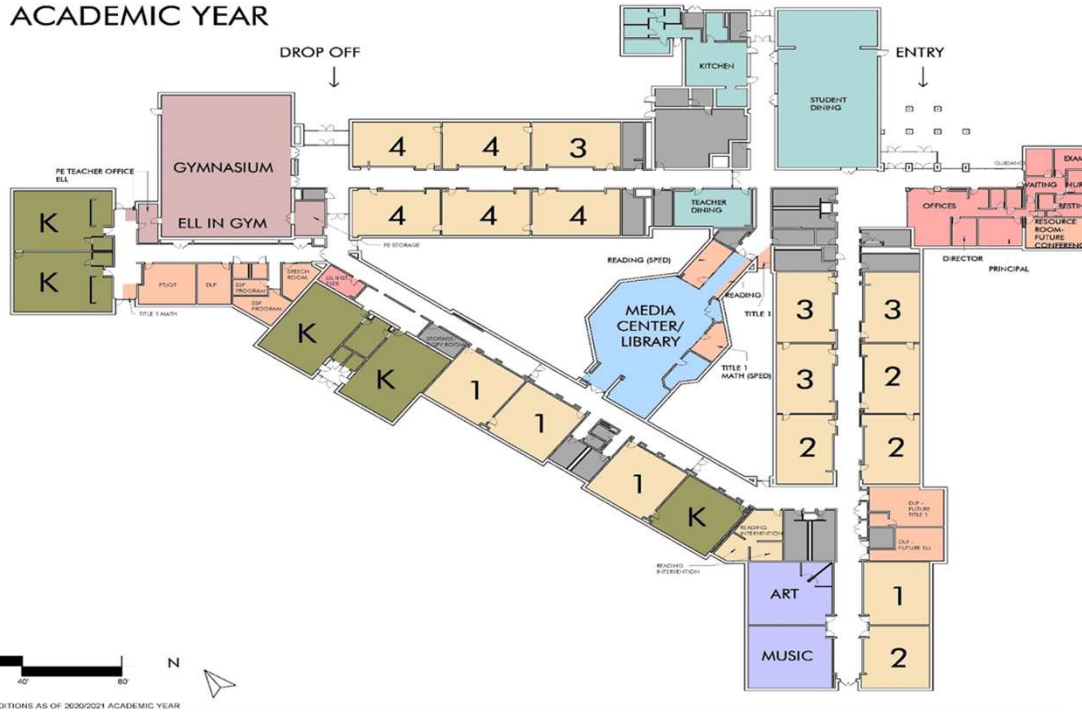

CAPACITY

22 K-4 GENERAL CLASSROOMS X 20 STUDENTS = 440 STUDENTS

2020-2021 ENROLLMENT = 461 STUDENTS

CAPACITY SHORT FALL

- 1 ADJ. COUNCILOR OFFICE
- 1 TECH OFFICE
- 1 READING TUTOR
- 1 TEACHER PLANNING
- 2 DLP ROOMS
- 3 SPED ROOMS (8 STUDENT CAPACITY)

EXISTING CONDITIONS AS OF 2020/2021 ACADEMIC YEAR
17 x 29' 0"

TAPPÉ ARCHITECTS, INC.
Six Edgerly Place, Boston, MA 02116

Huckleberry Hill School Conceptual Expansion Option

HUCKLEBERRY HILL ELEMENTARY SCHOOL

3/25/2020

EXPANSION CONCEPT

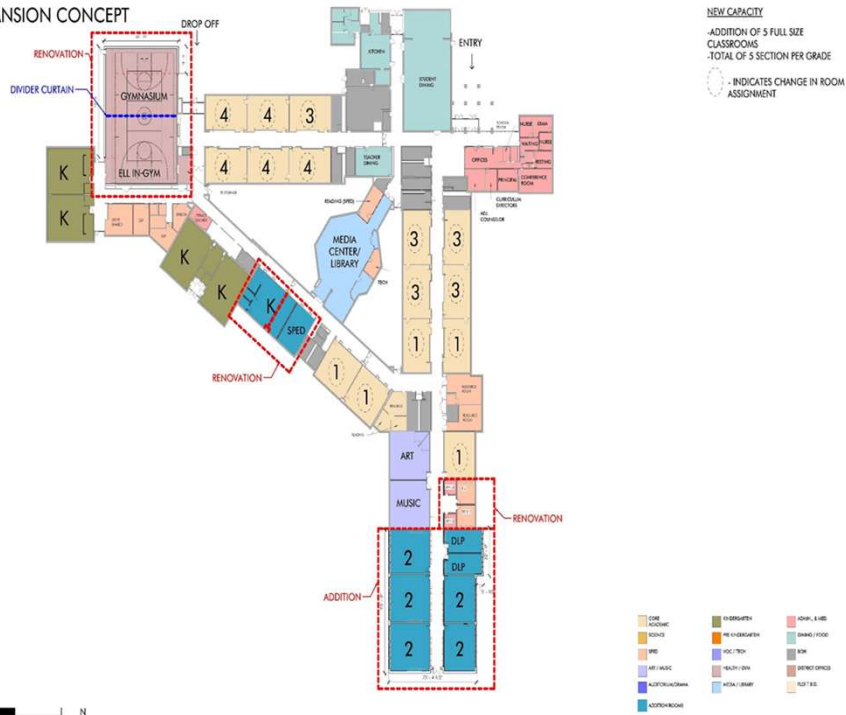

Current and Conceptual Design-Summer Street

Summer Street School Existing Floor Plan

SUMMER STREET ELEMENTARY SCHOOL

3/25/2020

EXISTING CONDITIONS PLAN 20/21 ACADEMIC YEAR

CAPACITY AS OF 2020/2021

21 K-4 GENERAL CLASSROOMS X 20 STUDENTS = 420 STUDENTS

2020/2021 PROJECTED ENROLLMENT = 412 STUDENTS

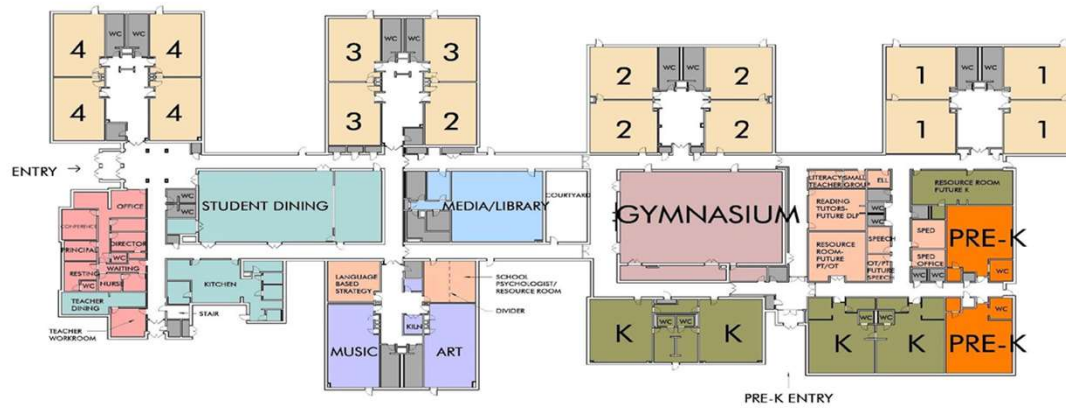

CAPACITY SHORT FALL

- 4 SPED (1 TEACHER, 8 STUDENTS)
- ELA TUTOR (2 TEACHERS, 4 STUDENTS)
- MATH TUTOR (2 TEACHERS, 4 STUDENTS)
- ADJUSTMENT COUNCILOR
- EXTERIOR STORAGE
- STORAGE



1 EXISTING CONDITION AS OF 2020/2021 ACADEMIC YEAR
1" = 20'-0"

 CORE ACADEMIC	 KINDERGARTEN	 ADMIN. & MED.
 SCIENCE	 PRE KINDERGARTEN	 DINING / FOOD
 SPED	 VOC / TECH	 BOH
 ART / MUSIC	 HEALTH / OYA	 DISTRICT OFFICES
 AUDITORIUM/DRAMA	 MEDIA / LIBRARY	 FLEX T.B.D.
 ADDITION/RENOVATION		



Summer Street School Conceptual Expansion Option

SUMMER STREET ELEMENTARY SCHOOL

3/25/2020

EXPANSION CONCEPT

NEW CAPACITY
4 CLASSROOM ADDITION TOTAL OF 5 SECTIONS PER GRADE

- INDICATES CHANGE IN ROOM ASSIGNMENT



Cost, Funding and Construction Timeline

➤ Cost

➤ Total estimated cost for the building project is \$17 million

- This dollar amount represents the all inclusive number (aka Full Project Cost Estimate)
 - Includes construction cost, consulting and design fees, project manager fees, basic furnishing costs for each new classroom as well as IT infrastructure costs)
 - The estimate includes the upgrade to the Huckleberry Hill playing field (irrigation and new grass)
 - The estimate is inclusive of construction contingencies and a budget for upgraded septic systems should it be determined that upgrades are needed at each school

➤ Funding

- The project cost would be funded by an appropriation through a debt exclusion vote by the Lynnfield Community
- The debt exclusion would be for 20 years and would cost the average household \$205.88/year on their property tax bill
 - This equates to roughly \$17/month per household...or about the same cost as a subscription to Netflix

➤ Construction Timeline

- The project would be scheduled to begin in the summer of 2021 and would be substantially completed by September 2022

Important Dates

- Saturday November 21, 2020
 - Special Town Meeting to review and make a recommendation on the project

- Tuesday December 8, 2020
 - Special Town Election to approve the debt exclusion funding